



15/30-34 Redbank Road Northmead NSW

2  2  1 

Ideally located within close proximity of multiple parks and reserves, Northmead Shopping Village, Northmead Public School, Westmead Hospital, Parramatta CBD and local and city buses, this location is sure to tick all the boxes.

View : <https://www.leroymageerealestate.com.au/lease/nsw/parramatta/northmead/residential/apartment/7783985>

Features:

- *HIGH ceilings, double brick construction
- *Combined living and dining area with low maintenance floating floorboards and split system A/C leading onto a balcony
- *Modern kitchen with GAS cooking, dishwasher, stone benchtops, ample storage
- *Master bedroom with mirrored built-in robe and ensuite
- *Secondary bedroom with built-in robe and additional private balcony
- *Stylish main bathroom with separate shower and bath and



Leroy Magee
963898

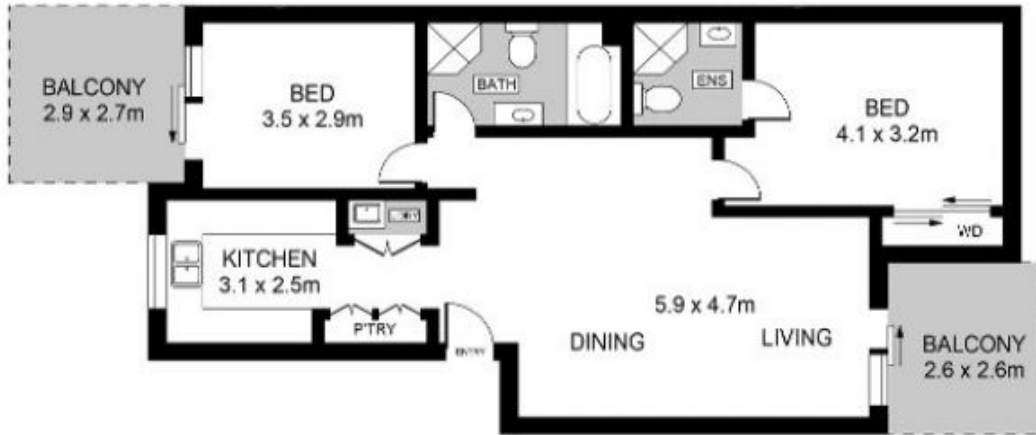
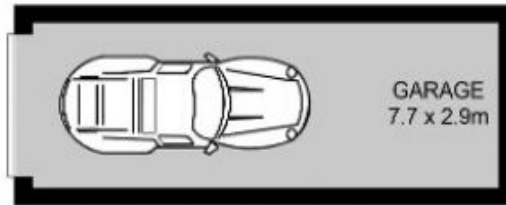

15/30 - 34 Redbank Road, Northmead

Aug 20

 CoreLogic